

NE 17th Water Main

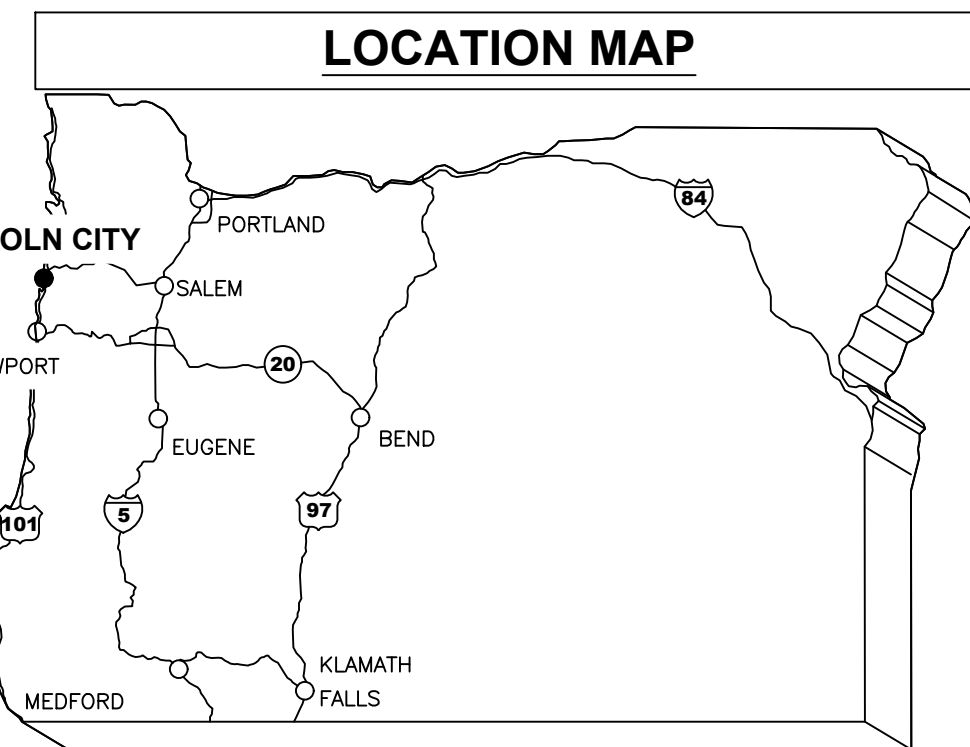

LEGEND	SYMBOL
Description	
Building Footprint	—
Centerline	—
Comm Line	C — C
Control Points	△
Demo	--- DEMO --- DEMO
Do not Demo	--- NO_DEMO --- NO_DEMO
Easements	—
Edge of Pavement (EOP)	—
Existing Asphalt	—
Existing Asphalt Pattern	—
Existing Concrete	—
Existing Concrete Pattern	—
Fences	—
Fiberoptic, TV or Telephone Structures	C
Gas Distribution Main	G — G
Gas Distribution Service	G — G
Gas Valve	⊕
Guy Anchor	—
Junction Box	⊠
Miscellaneous Points	X
Overhead Wire	OH — OH
Power Structure	⊠
Proposed Asphalt	—
Proposed Asphalt Pattern	—
Proposed Concrete	—
Proposed Concrete Pattern	—
Proposed Sawcut or Mill	—
Extent	—
Sewer Cleanout	⊕
Sewer Gravity Main	SS — SS
Sewer Lateral	SS — SS
Sewer Manhole	⊕
Sewer Pressurized Main	—
Sewer Structures	—
Sign	—
Signal Poles, Power Pole	⊕
Storm Catch Basin	⊠
Storm Culvert	—
Storm Ditch	ST — ST
Storm Gravity Main	ST — ST
Storm Sewer NEW piping	—
Storm Sewer NEW structures	—
Storm/Drainage Manhole	⊕
Taxlot	—
Test Pits/Bore holes	⊕
Topo—Bench Mark	△
Topo—major contours, NEW	—
Topo—major gridlines	—
Topo—minor contours, NEW	—
Vege—Shrub	⊕
Vege—Tree Deciduous	○
Vege—Tree Evergreen	●
Water Fire Hydrant	⊕
Water Meter	⊕
Water Pressurized Main	—
Water Service Lateral	—
Water Valve	⊕
Water—New Pipe	—
Water—Pipe Restraint	—

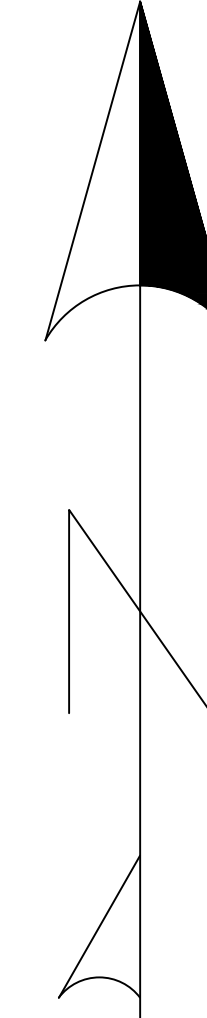
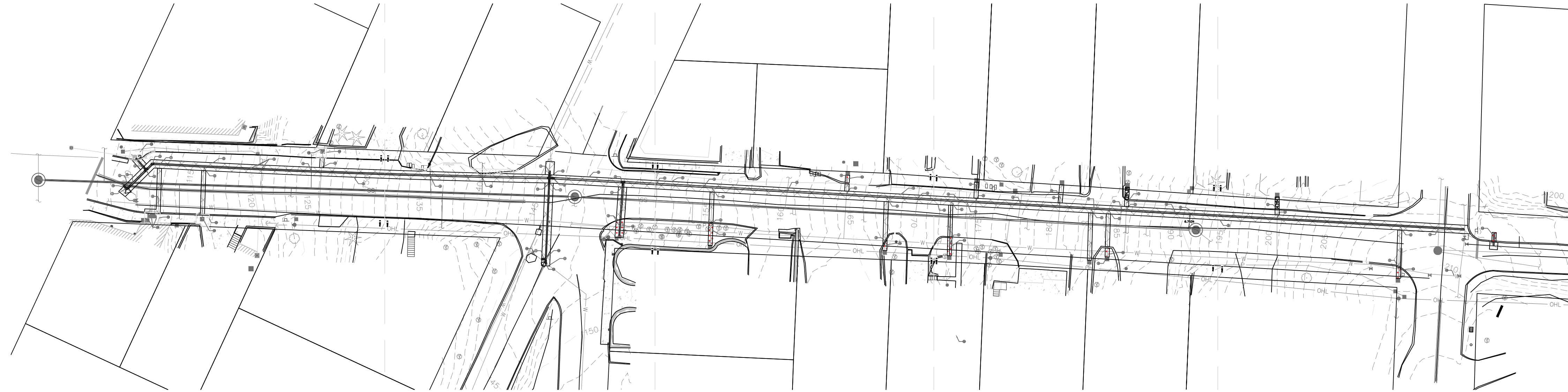
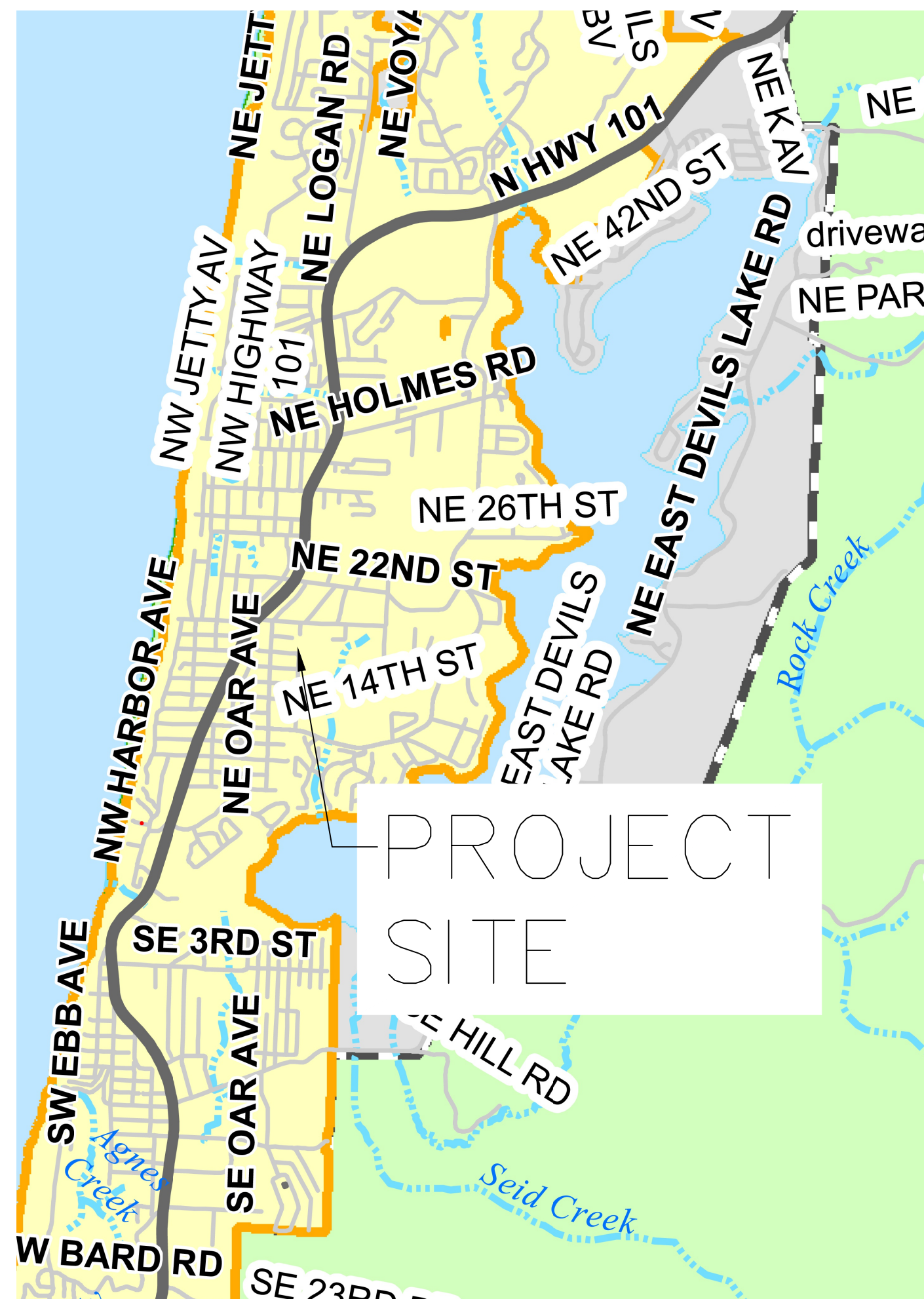

GENERAL NOTES:

- ALL CONSTRUCTION ACTIVITIES SHALL BE LIMITED TO THE HOURS BETWEEN 7:00 AM AND 7:00 PM, MONDAY THROUGH FRIDAY, UNLESS OTHERWISE APPROVED BY THE ENGINEER.
- CONTRACTOR SHALL PROVIDE ALL APPLICABLE PUBLIC AND PRIVATE CONSTRUCTION NOTIFICATION. IMPACT TO PROPERTY ACCESS SHALL BE PROVIDED TO RESIDENTS IN WRITING 48 HOURS PRIOR.
- UTILITY TRENCHES SHALL BE PAVED WITHIN 48 HOURS OF WORK BEING COMPLETED. IF EXTENDING LONGER THAN 48-HOURS, CUTS SHALL BE PATCHED WITH TEMPORARY, COLD-MIX ACP.
- LOCATIONS AND DESCRIPTIONS OF ALL EXISTING UTILITIES OR OTHER OBSTRUCTIONS SHOWN IN THE PROJECT PLANS ARE COMPILED FROM AVAILABLE RECORDS AN/OR FIELD SURVEYS. ACCURACY AND COMPLETENESS ARE NOT GUARANTEED; CONTRACTOR SHALL FIELD-VERIFY ALL UTILITY LOCATIONS PRIOR TO CONSTRUCTION.
- ASSUMED UTILITY DEPTHS HAVE BEEN BASED ON AVAILABLE SURFACE INFORMATION AND/OR STANDARD INSTALLATION DEPTHS AND CROSSING HAVE BEEN SHOWN FOR CLARITY ONLY. CONTRACTOR SHALL BE RESPONSIBLE FOR POTHOLING ALL UTILITY CROSSINGS PRIOR TO THE START OF CONSTRUCTION. ELEVATIONS CONFLICTING WITH DESIGN SLOPES & ELEVATIONS MAY REQUIRE FIELD ADJUSTMENT. CONFLICTS BEYOND FIELD ADJUSTING SHALL BE PROVIDED TO THE DESIGN ENGINEER FOR FURTHER DESIGN & DIRECTION AS NEEDED.
- CONTRACTOR SHALL BE RESPONSIBLE FOR ANY DAMAGE THAT OCCURS TO ASPHALT PAVEMENT, CONCRETE PAVEMENT, CONCRETE STRUCTURES, BUILDINGS, VALVE AND/OR METER BOXES, SIGNS, PRIVATE PROPERTY, ETC. DUE TO CONSTRUCTION ACTIVITIES.
- NO OPEN EXCAVATION TO BE LEFT DURING CONSTRUCTION OFF HOURS. ALL OPEN CUTS OF EXISTING STREETS AND DRIVEWAYS TO BE BACKFILLED TO GRADE, PATCHED WITH A HOT OR COLD AC MIX, OR COVERED WITH A STEEL PLATE.
- EFFECTIVE EROSION CONTROL IS REQUIRED. EROSION CONTROL DEVICES MUST BE INSTALLED AND MAINTAINED MEETING CITY AND D.E.Q. REQUIREMENTS.
- THE ADJUSTMENT OF ALL EXISTING APPURTENANCES SHALL BE CONSIDERED INCIDENTAL IF NOT LISTED IN THE BID SCHEDULE.
- RESTORATION SHALL BE COMPLETED TO ALL PROPERTIES AFFECTED BY CONSTRUCTION ACTIVITIES AND SHALL BE CONSIDERED INCIDENTAL TO THIS PROJECT.
- ROOTS OF ADJACENT TREES & SHRUBS DISTURBED DURING THE COURSE OF CONSTRUCTION SHALL BE CLEAN CUT WITH ADEQUATELY SHARP SHEARS OR SAW AND LEFT EXPOSED TO THE AIR FOR HEALING & INSPECTION BY LINCOLN CITY PUBLIC WORKS.
- ROAD SHOULDERS SHALL HAVE A MINIMUM OF 3" OF 3/4"-0 GRAVEL.
- ROAD SHALL BE CONSTRUCTED WITH 12" OF COMPACTED 3/4"-0 GRAVEL WITH 4" OF LEVEL 2, 1/2" DENSE ACP.
- ASPHALT DRIVEWAY TRANSITIONS SHALL HAVE MINIMUM OF 10" OF 3/4"-0 COMPACTED GRAVEL WITH 3" OF LEVEL 2, 1/2" DENSE ACP.
- ROAD SHOULDERS SHALL HAVE A MINIMUM OF 3" OF 3/4"-0 GRAVEL.

General Notes
OWNER: LINCOLN CITY
 CITY OF LINCOLN CITY
 801 SW HIGHWAY 101
 PO BOX 50
 LINCOLN CITY, OREGON 97367
CONTACT: TERRY CHAMBERLIN, P.E.
 PHONE: 541.996.1292



No.	Revision/Issue	Date

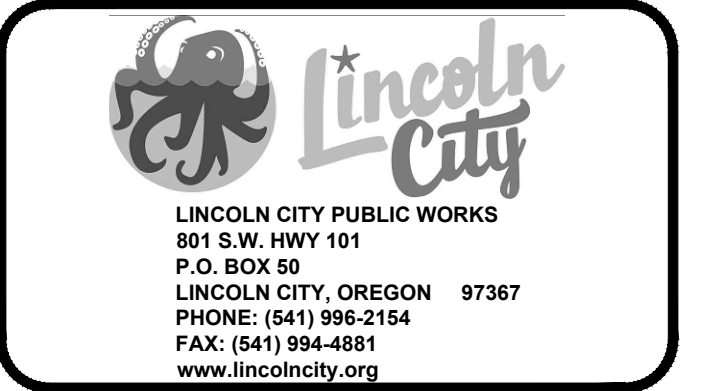

Project Name and Sheet Name
 NE 17th Water Main Relocation
DESIGNED BY: TC
PREPARED BY: JR

Project No.: 25020	Sheet No. 1 OF 7
Date: 1/7/2026	Scale: 1" = 5'
IF LESS THAN FULL SIZE, NTS	

NE 17th Water Main

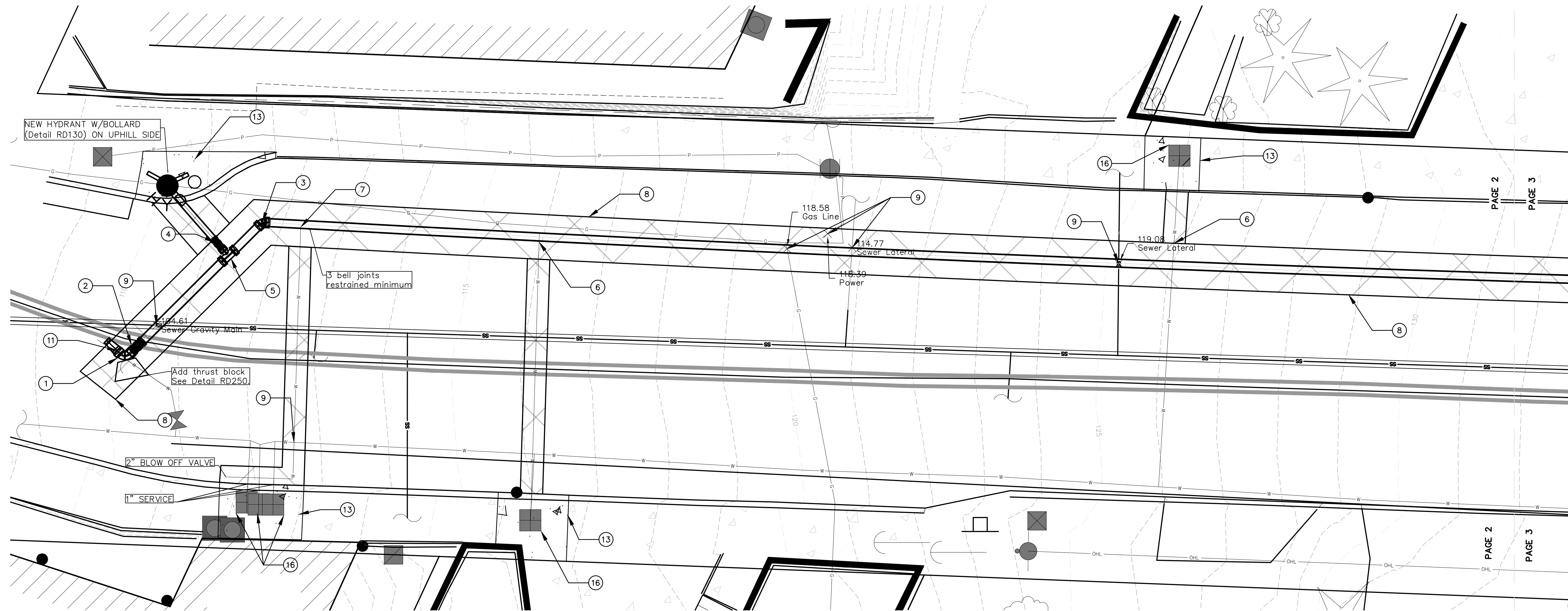

5+20.00-6+50.68

Station

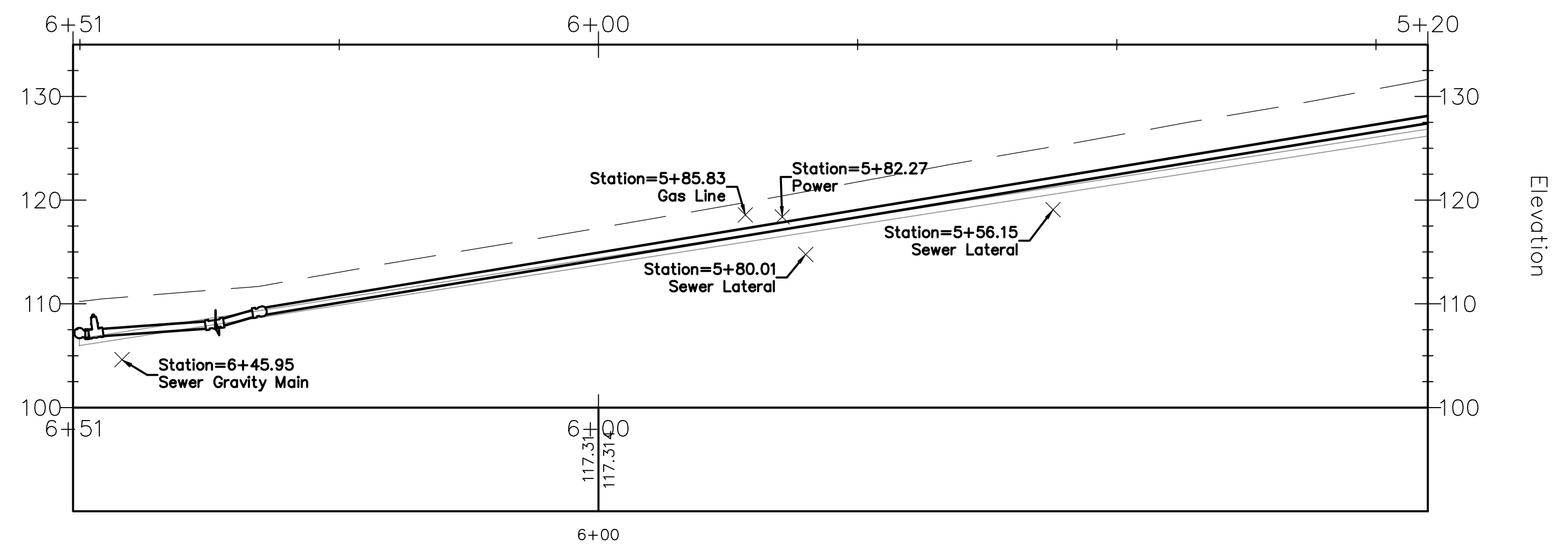

①	8" 90° Bend with Reducer to existing 6" PVC
②	8" Gate Valve FLxMJ
③	45° Bend MJxMJ
④	6" Gate Valve FLxMJ
⑤	6"x8" TEE MJxFLxMJ
⑥	1" Service
⑦	2" Service w/ 2" square nut valve
⑧	Sawcut & Remove existing ACP. Replace with 4" ACP. If existing asphalt is greater than 4", match existing
⑨	Pothole for existing utilities
⑩	Cut and Cap abandoned water main. Restrain as needed.
⑪	Tie New 8" PVC into existing 6" PVC Water Main with Reducer. Use Fittings as needed.
⑫	Tie into existing 6" Water Main
⑬	Demo and Replace Curb and Sidewalk as needed
⑭	Restore landscaping and hydroseed existing grass
⑮	6" x 6" Tee FLxFLxMJ
⑯	Replace water meter box

General Notes
 OWNER: LINCOLN CITY
 CITY OF LINCOLN CITY
 801 SW HIGHWAY 101
 PO BOX 50
 LINCOLN CITY, OREGON 97367
 CONTACT: TERRY CHAMBERLIN, P.E.
 PHONE: 541.996.1292

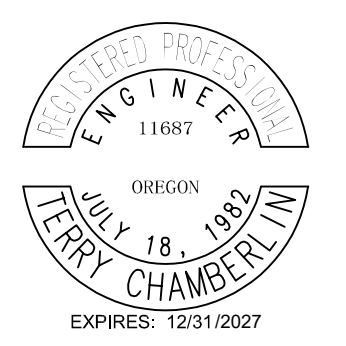

No.	Revision/Issue	Date

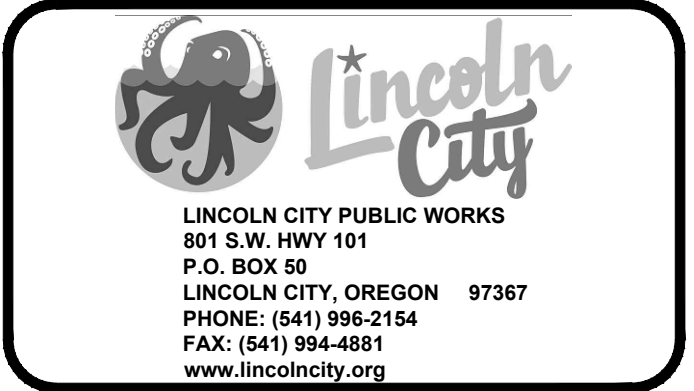

Project Name and Sheet Name
NE 17th Water Main Relocation
 DESIGNED BY: TC
 PREPARED BY: JR

Project No.: **25020** Sheet No.: **2 OF 7**
 Date: **1/7/2026**
 Scale: **1" = 5'**
IF LESS THAN FULL SIZE, NTS

J:\Engineering Capital Projects\25020 NE 17th Water (Hwy 101 to Oar)\CAD

1/7/2026

NE 17th Water Main

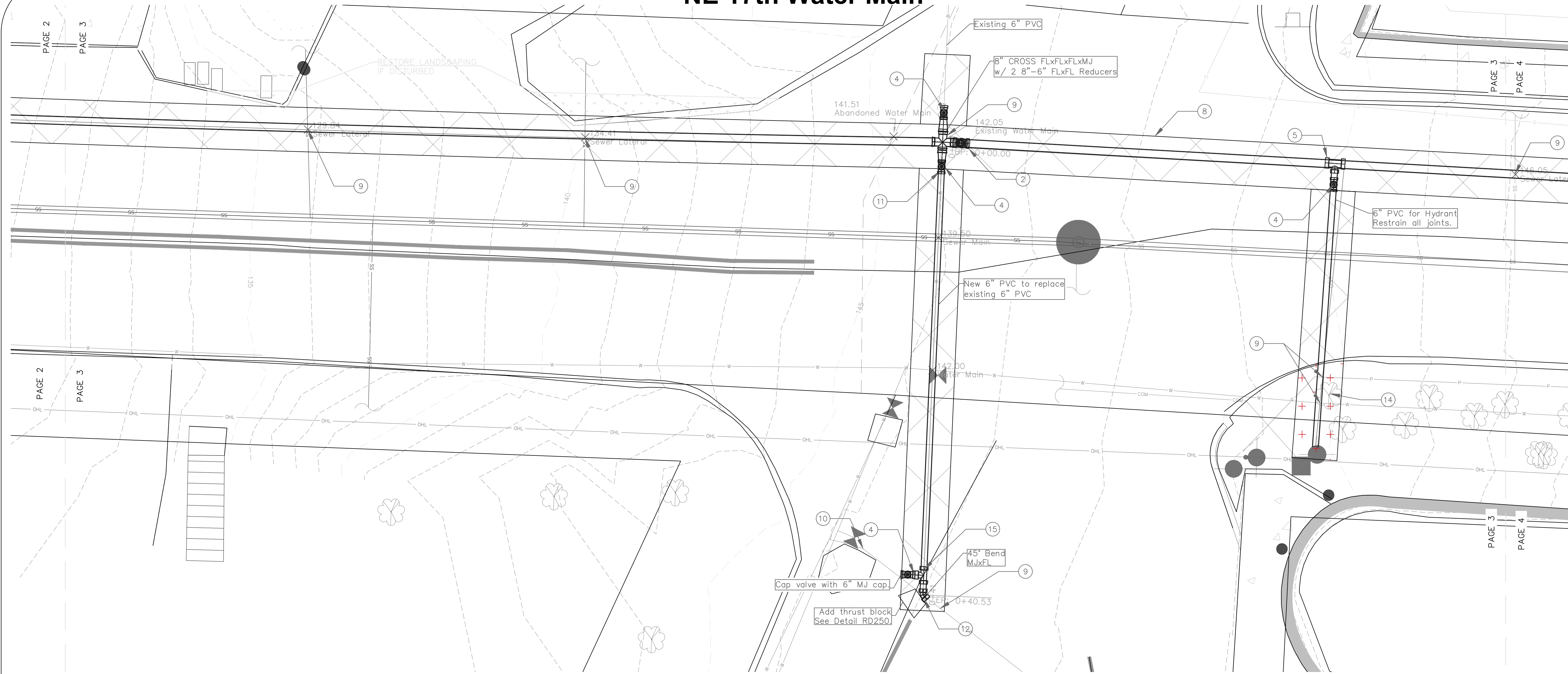

3+90.00-5+20.00

Station

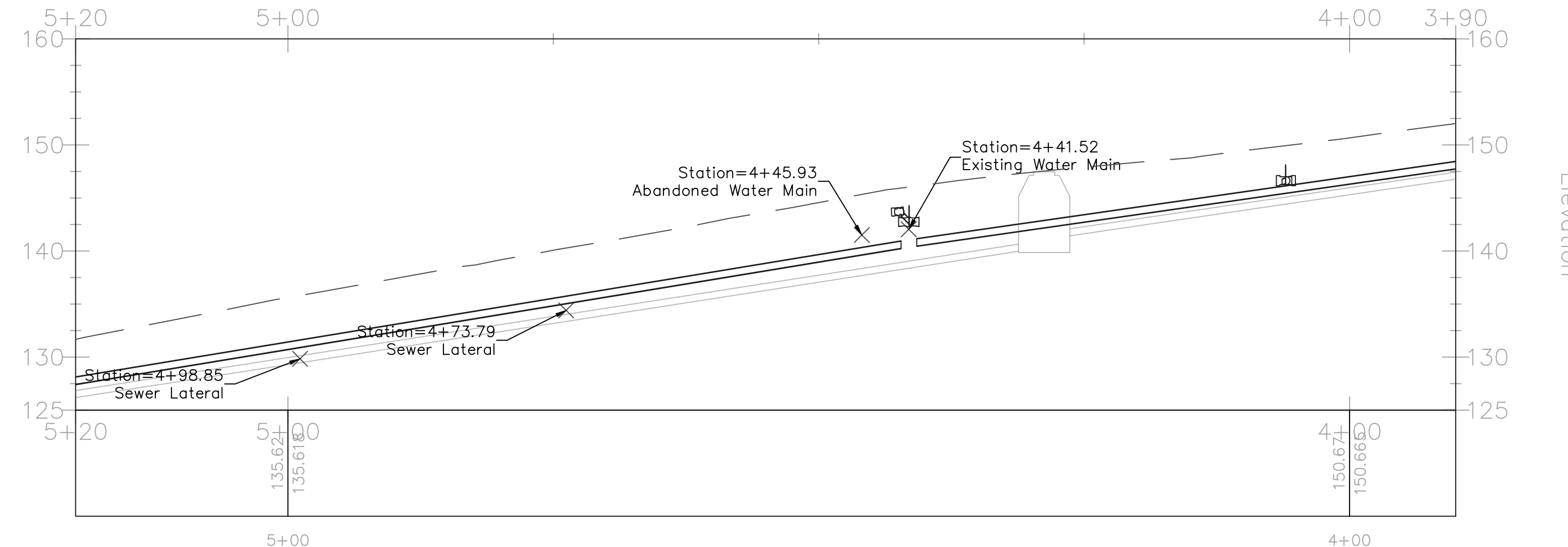

Elevation

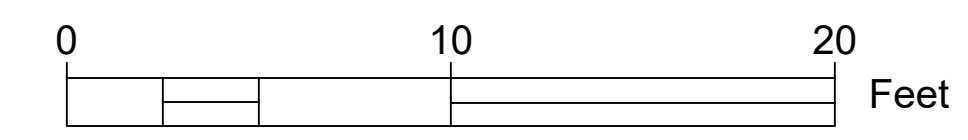
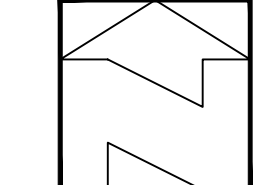

①	8" 90° Bend with Reducer to existing 6" PVC
②	8" Gate Valve FLxMJ
③	45° Bend MJxMJ
④	6" Gate Valve FLxMJ
⑤	6"x8" TEE MJxFLxMJ
⑥	1" Service
⑦	2" Service w/ 2" square nut valve
⑧	Sawcut & Remove existing ACP. Replace with 4" ACP. If existing asphalt is greater than 4", match existing
⑨	Pothole for existing utilities
⑩	Cut and Cap abandoned water main. Restrain as needed.
⑪	Tie New 8" PVC into existing 6" PVC Water Main with Reducer. Use Fittings as needed.
⑫	Tie into existing 6" Water Main
⑬	Demo and Replace Curb and Sidewalk as needed
⑭	Restore landscaping and hydroseed existing grass
⑮	6" x 6" Tee FLxFLxMJ
⑯	Replace water meter box

General Notes
 OWNER: LINCOLN CITY
 CITY OF LINCOLN CITY
 801 SW HIGHWAY 101
 PO BOX 50
 LINCOLN CITY, OREGON 97367
 CONTACT: TERRY CHAMBERLIN, P.E.
 PHONE: 541.996.1292



No.	Revision/Issue	Date

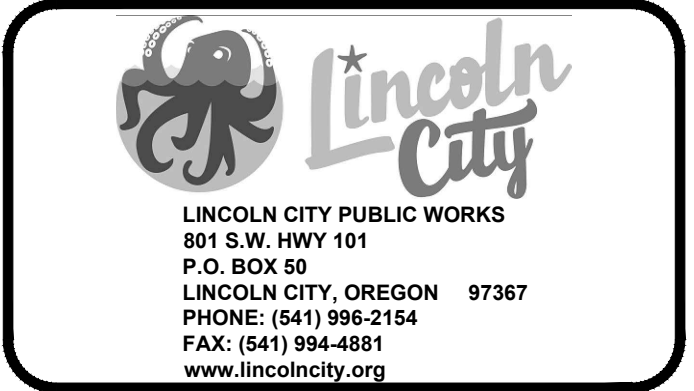

Project Name and Sheet Name
 NE 17th Water Main Relocation
 DESIGNED BY: TC
 PREPARED BY: JR

Project No.: 25020	Sheet No. 3 OF 7
Date: 1/7/2026	
Scale: 1" = 5' IF LESS THAN FULL SIZE, NTS	

J:\Engineering Capital Projects\25020 NE 17th Water (Hwy 101 to Oar)\CAD

1/7/2026

NE 17th Water Main

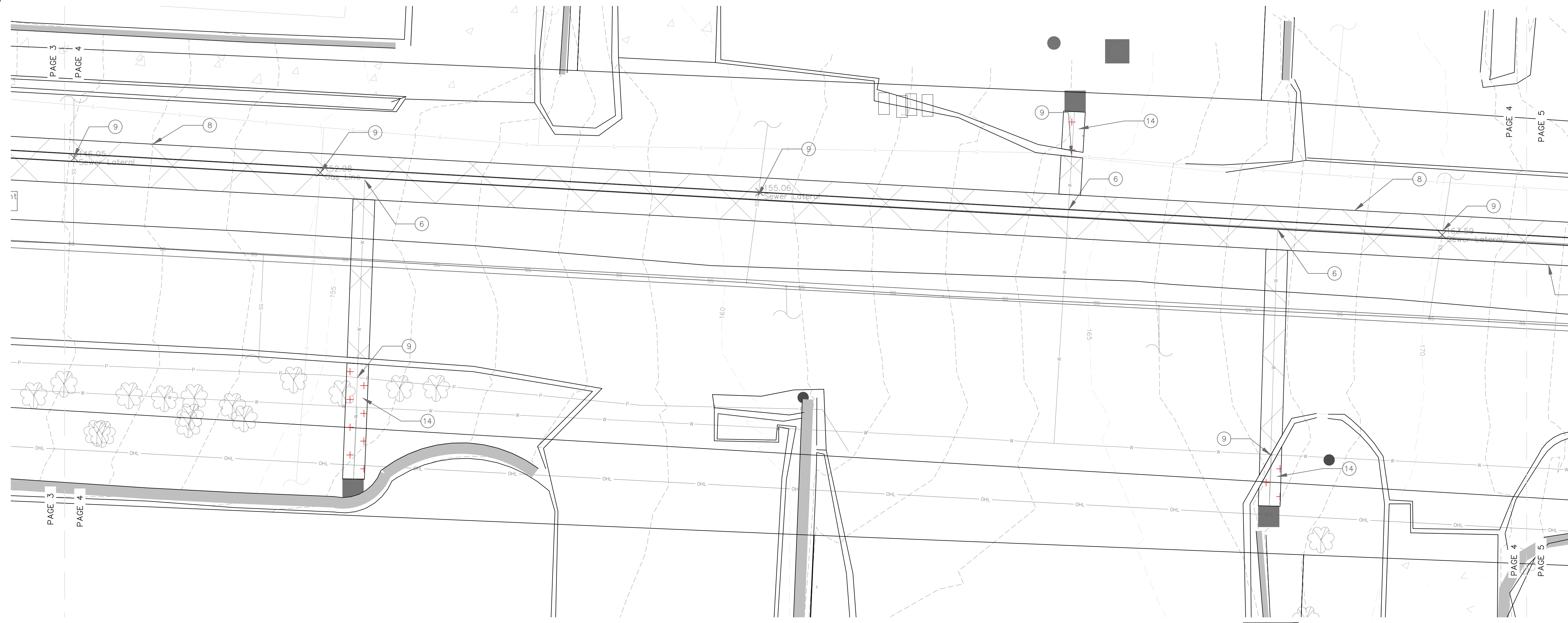

2+60.00 - 3+90.00

Station

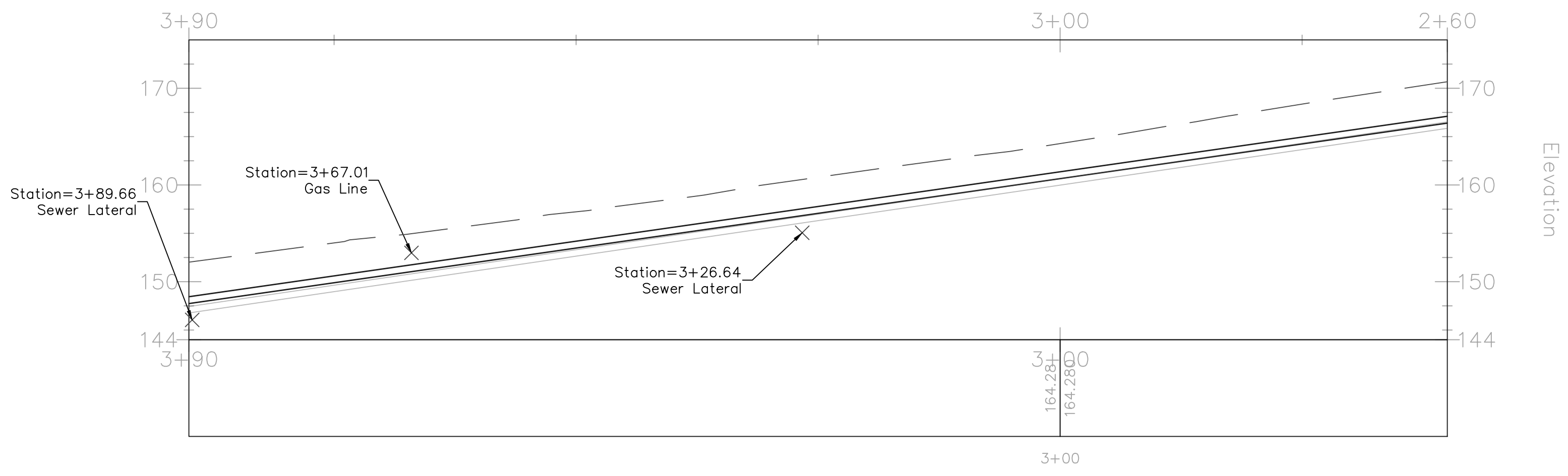

①	8" 90° Bend with Reducer to existing 6" PVC
②	8" Gate Valve FLxMJ
③	45° Bend MJxMJ
④	6" Gate Valve FLxMJ
⑤	6"x8" TEE MJxFLxMJ
⑥	1" Service
⑦	2" Service w/ 2" square nut valve
⑧	Sawcut & Remove existing ACP. Replace with 4" ACP. If existing asphalt is greater than 4", match existing
⑨	Pothole for existing utilities
⑩	Cut and Cap abandoned water main. Restrain as needed.
⑪	Tie New 8" PVC into existing 6" PVC Water Main with Reducer. Use Fittings as needed.
⑫	Tie into existing 6" Water Main
⑬	Demo and Replace Curb and Sidewalk as needed
⑭	Restore landscaping and hydroseed existing grass
⑮	6" x 6" Tee FLxFLxMJ
⑯	Replace water meter box

General Notes
 OWNER: LINCOLN CITY
 CITY OF LINCOLN CITY
 801 SW HIGHWAY 101
 PO BOX 50
 LINCOLN CITY, OREGON 97367
 CONTACT: TERRY CHAMBERLIN, P.E.
 PHONE: 541.996.1292

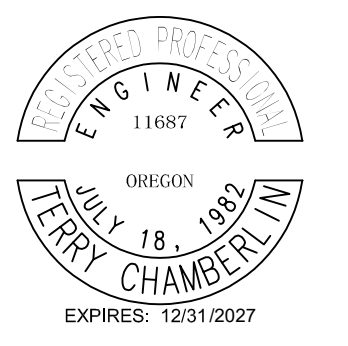

No.	Revision/Issue	Date

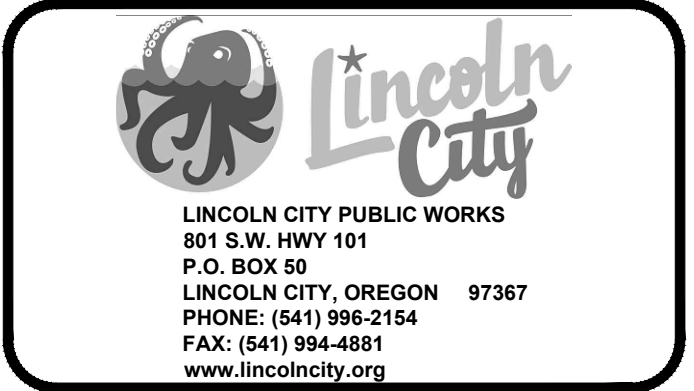

Project Name and Sheet Name
 NE 17th Water Main Relocation
 DESIGNED BY: TC
 PREPARED BY: JR

Project No.: 25020	Sheet No. 4 OF 7
Date: 1/7/2026	
Scale: 1" = 5' IF LESS THAN FULL SIZE, NTS	

J:\Engineering Capital Projects\25020 NE 17th Water (Hwy 101 to Oar)\CAD

1/7/2026

NE 17th Water Main

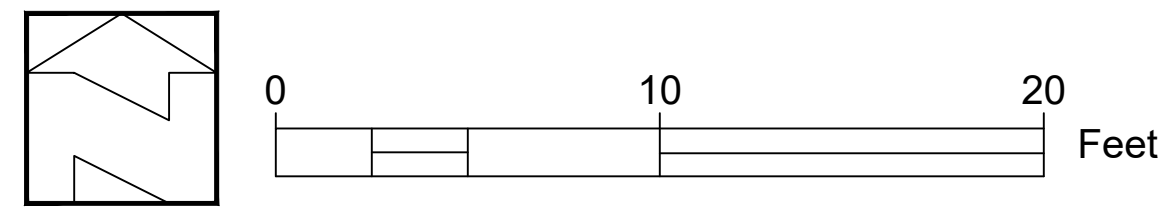
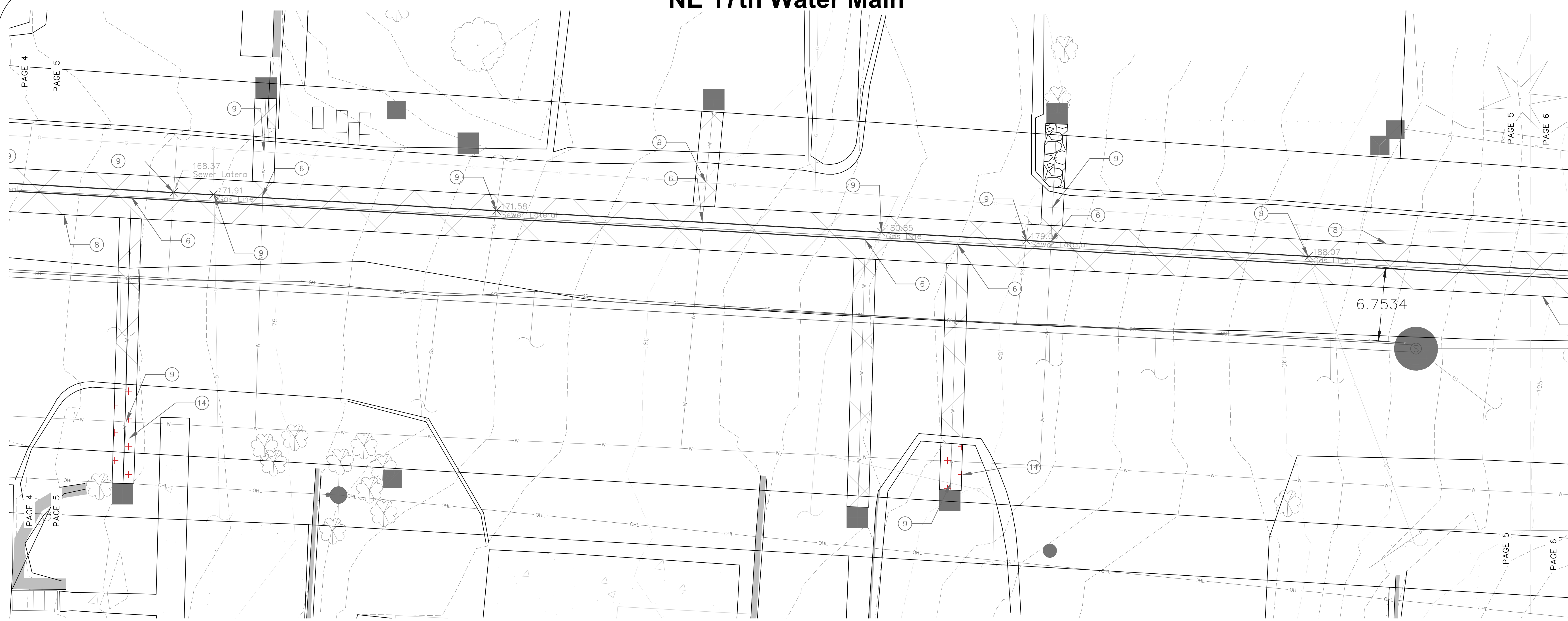

1+25.00-2+60.00

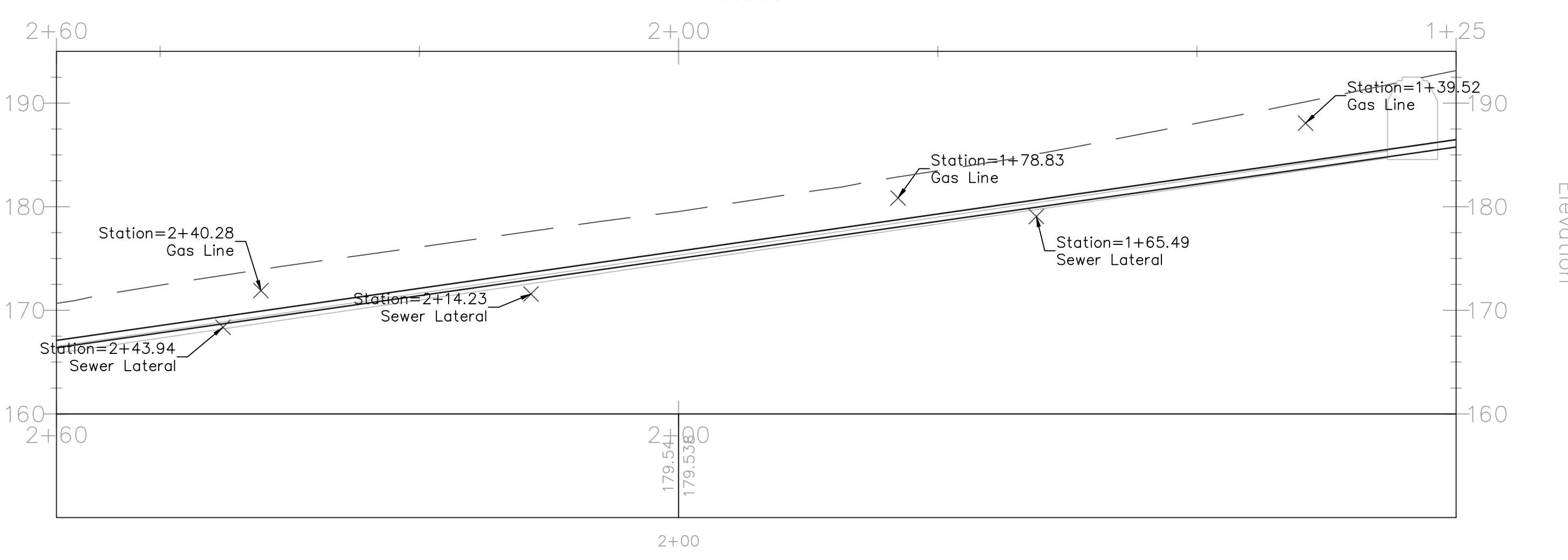

①	8" 90° Bend with Reducer to existing 6" PVC
②	8" Gate Valve FLxMJ
③	45° Bend MJxMJ
④	6" Gate Valve FLxMJ
⑤	6"x8" TEE MJxFLxMJ
⑥	1" Service
⑦	2" Service w/ 2" square nut valve
⑧	Sawcut & Remove existing ACP. Replace with 4" ACP. If existing asphalt is greater than 4", match existing
⑨	Pothole for existing utilities
⑩	Cut and Cap abandoned water main. Restrain as needed.
⑪	Tie New 8" PVC into existing 6" PVC Water Main with Reducer. Use Fittings as needed.
⑫	Tie into existing 6" Water Main
⑬	Demo and Replace Curb and Sidewalk as needed
⑭	Restore landscaping and hydroseed existing grass
⑮	6" x 6" Tee FLxFLxMJ
⑯	Replace water meter box

General Notes
 OWNER: LINCOLN CITY
 CITY OF LINCOLN CITY
 801 SW HIGHWAY 101
 PO BOX 50
 LINCOLN CITY, OREGON 97367
 CONTACT: TERRY CHAMBERLIN, P.E.
 PHONE: 541.996.1292



No.	Revision/Issue	Date

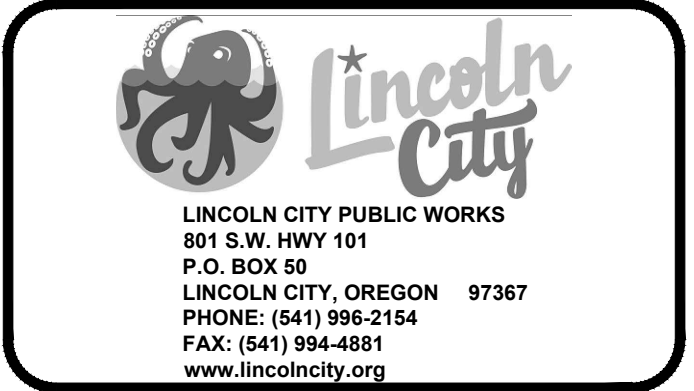

Project Name and Sheet Name
 NE 17th Water Main Relocation
 DESIGNED BY: TC
 PREPARED BY: JR

Project No.: 25020	Sheet No. 5 OF 7
Date: 1/7/2026	
Scale: 1" = 5' IF LESS THAN FULL SIZE, NTS	

J:\Engineering Capital Projects\25020 NE 17th Water (Hwy 101 to Oar)\CAD

1/7/2026

NE 17th Water Main

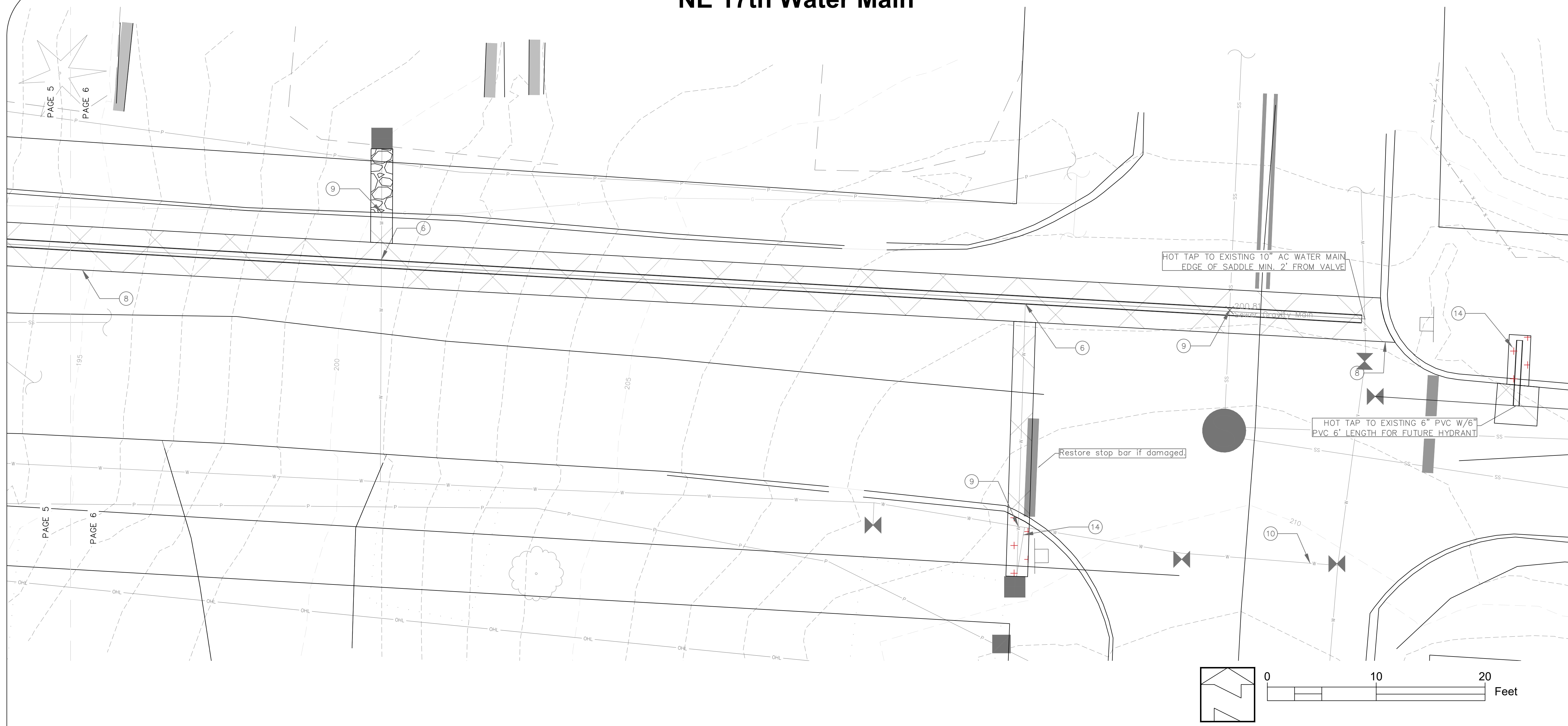

0+00.00-1+30.00
Station

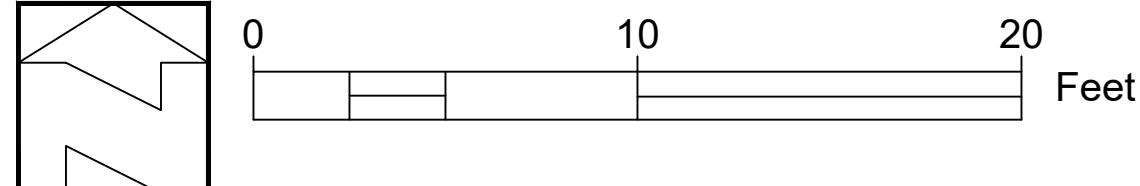
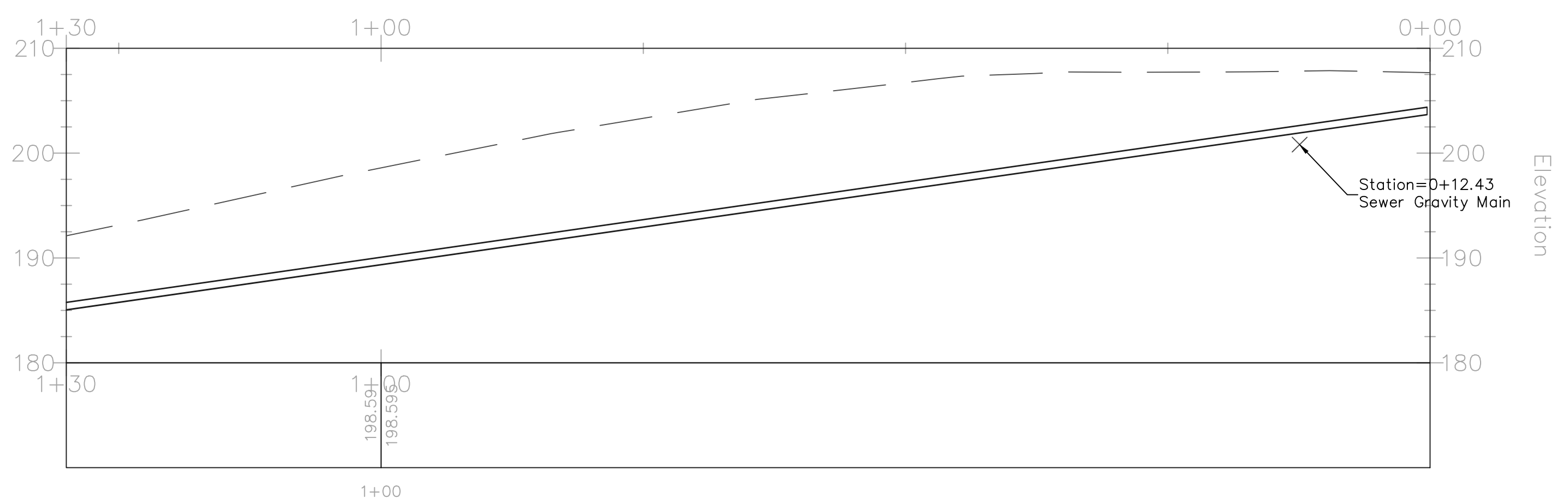

①	8" 90° Bend with Reducer to existing 6" PVC
②	8" Gate Valve FLxMJ
③	45° Bend MJxMJ
④	6" Gate Valve FLxMJ
⑤	6"x8" TEE MJxFLxMJ
⑥	1" Service
⑦	2" Service w/ 2" square nut valve
⑧	Sawcut & Remove existing ACP. Replace with 4" ACP. If existing asphalt is greater than 4", match existing
⑨	Pothole for existing utilities
⑩	Cut and Cap abandoned water main. Restrain as needed.
⑪	Tie New 8" PVC into existing 6" PVC Water Main with Reducer. Use Fittings as needed.
⑫	Tie into existing 6" Water Main
⑬	Demo and Replace Curb and Sidewalk as needed
⑭	Restore landscaping and hydroseed existing grass
⑮	6" x 6" Tee FLxFLxMJ
⑯	Replace water meter box

General Notes

OWNER: LINCOLN CITY
CITY OF LINCOLN CITY
801 SW HIGHWAY 101
PO BOX 50
LINCOLN CITY, OREGON 97367

CONTACT: TERRY CHAMBERLIN, P.E.
PHONE: 541.996.1292

No.	Revision/Issue	Date

LINCOLN CITY PUBLIC WORKS
801 S.W. HWY 101
P.O. BOX 50
LINCOLN CITY, OREGON 97367
PHONE: (541) 996-2154
FAX: (541) 994-4881
www.lincolncity.org

Project Name and Sheet Name

NE 17th Water Main Relocation

DESIGNED BY: TC
PREPARED BY: JR

<small>Project No.:</small> 25020	<small>Sheet No.:</small>
<small>Date:</small> 1/7/2026	6 OF 7
<small>Scale:</small> 1" = 5' <small>IF LESS THAN FULL SIZE, NTS</small>	

J:\Engineering Capital Projects\25020 NE 17th Water (Hwy 101 to Oar)\CAD

1/7/2026

